



COWAY LOVES THE PLANET
This paper can be recycled.

Coway

Coway Air Purifier AP-0509DH

- This product is for domestic use only. It cannot be used in an overseas country where the power voltage is different.
- Warranty card is included in this user's manual.
- Read and save these instructions.

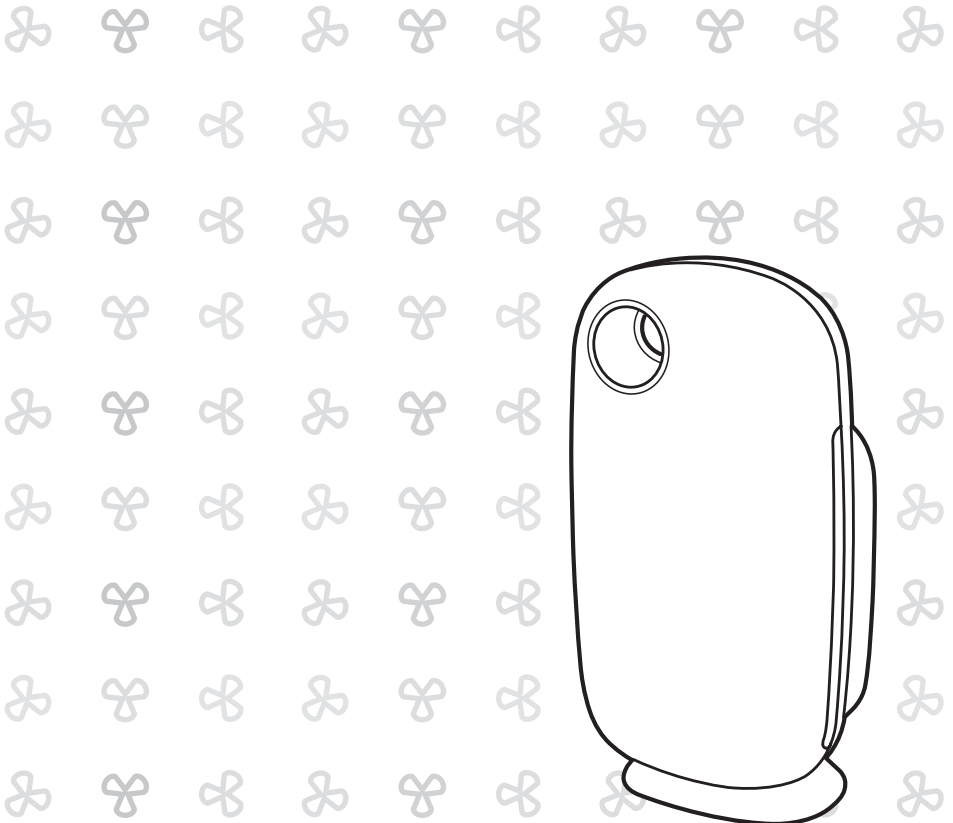

FEATURES

1. ANTI-FLU HEPA™ filter system

Coway's innovative ANTI-FLU HEPA™ captures micro particles and inactivates viruses up to 99.9 %. Natural substances from Ginkgo and Japanese sumac trees destroy the protein on the surface of viruses.

* This appliance is not a medical device.



2. UFY(Ultra fine yarn)pre-filter

It removes the comparatively dust and mold and protects the medium deodorization filter and ANTI-FLU HEPA™ filter. By using UFY, it decreases pressure drop of filter system and increases dust collection efficiency. It is used the water repellent to clean easy and decrease dry time.

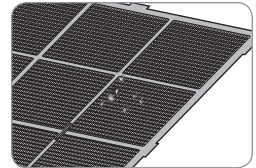

3. Slim design

The slim design makes the product fit well in any place in harmony with the surroundings.



DEAR CUSTOMERS

Thank you for using the **Coway air purifier**.

Please read the user's manual to use and maintain the product correctly.

If you encounter a problem while using the product, you may easily solve the problem by referring to the user's manual. As this manual contains the product warranty card, please keep it in a safe place.

CONTENTS

FOR INFORMATION

- | 03 | SAFETY INFORMATION
 - Danger
 - Warning
 - Caution
- | 07 | PARTS NAME
- | 08 | AIR PURIFIED PROCESS

MAINTENANCE

- | 13 | CLEANING METHOD
- | 15 | FILTER REPLACEMENT

HOW TO USE

- | 09 | PREPARATIONS
- | 10 | INDICATORS AND CONTROLS
- | 12 | HOW TO USE

OTHERS

- | 16 | TROUBLESHOOTING
- | 17 | SPECIFICATION

SAFETY INFORMATION

The following information is for user safety that should be observed.

It is to ensure user safety and prevent property damage. Please read the precautions carefully and use the product correctly.



for 220 V - 240 V~ use only



for 120 V~ use only

▲ Danger : If not observed, serious injury or even death could occur.

- Do not use a damaged power plug or loose electric outlet.
- Make sure to connect the power plug to a dedicated electric outlet for 220 V -240 V~, 50 Hz/60 Hz.
- Do not move the product by pulling the power cord.
- Do not handle the power plug with a wet hand.
- Do not forcibly bend the power cord or run it under a heavy object to prevent it from being damaged or deformed.
- Do not plug in and plug out the power plug repeatedly.
- If the electric outlet is wet, carefully unplug the product and let the electric outlet completely dry before subsequent use.
- Unplug the product before repair, inspection, or parts replacement.
- Unplug the product if it is not to be used for a long time.
- Do not attempt to repair or modify the power cord.
- Remove any dust or water from the power plug.
- Do not plug into an electric outlet or power strip that is being used by several other appliances. Use an electric outlet dedicated to the product.
- If the power cord is damaged, do not replace the cord yourself. Call coway service center to have it replaced.
- Do not install the air purifier near a heating device.
- Do not place the product on top of an electrical appliance such as a heater or tv.

-
- Do not install the product in areas where moisture, dust or water (rainwater) is present.
 - Do not use the product in areas where flammable gases or combustible materials are used or stored.
 - If the air purifier produces a strange noise, burning smell, or smoke, immediately remove the power plug from the electric outlet and call our service center.
 - Never put the product in water.
 - Do not spray any flammable materials such as insecticides or fragrances to the air inlet.
 - Do not disassemble, repair, or modify the product.
 - Do not place on top of the product any containers with water, medicine, food, any metallic objects, or any flammable material.
 - Unplug the product before you clean it.

SAFETY INFORMATION

▲ Warning : If not observed, serious injury or property damage could occur.

- Do not clean the product by applying water directly to the product or using benzene or thinner.
- Do not stick fingers or foreign objects into the air inlet or outlet.
- Do not let children hang on to the product or climb on it.
- When removing the front cover, exercise caution not to have part of you body or other objects stuck in the upper part of the product.
- This appliance is not intended for use by persons (including children) with reduced physical, sensory or mental capabilities, or lack of experience and knowledge, unless they have been given supervision or instruction concerning use of the appliance by a person responsible for their safety.
- Children should be supervised to ensure that they do not play with the appliance.
- This appliance can be used by children aged from 8 years and above.

▲ Caution : If not observed, slight injury or property damage could occur.

- Do not install the product on a sloped floor.
- Do not exert excessive force or shock on the product.
- When the product is in use, maintain a distance of at least 20 cm from walls or adjacent objects and 30 cm - 60 cm above the product.
- Install the product where no obstacles around the product block the circulation of air.
- Use the air purifier away from lighting devices or direct sunlight.

-
- Install the air purifier at least 2 m away from electronic products such as tv.
 - Do not use the product in areas where it will be subjected to heavy smoke, odors, or oil.
 - Do not use the air purifier in a location exposed to direct sunlight.
 - Replace filters with new ones according to filter replacement cycles.
 - Clean the pre-filter with water regularly and dry completely before use.
 - Do not push or lean against this product, as it may topple over the product.
 - Never let children insert their hands into the hole.

PARTS NAME

Front / Rear

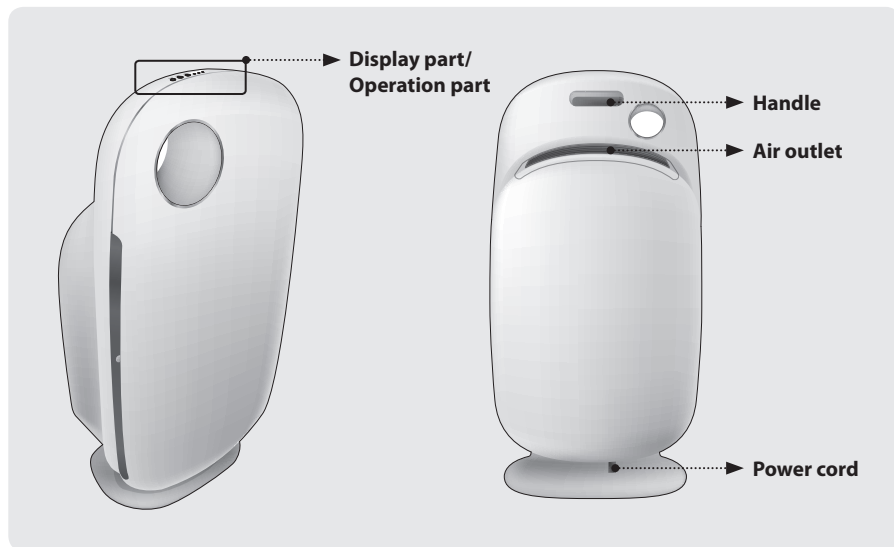

Others



User's manual

AIR PURIFIED PROCESS

■ UFY(Ultra Fine Yarn) pre-filter

It removes the comparatively dust and mold and protects the medium deodorization filter and ANTI-FLU HEPA™ filter. By using UFY, it decreases pressure loss and increases dust collection efficiency.

■ Medium deodorization filter

Medium deodorization filter removes the medium dust and the gases, and it protects the HEPA filter.

Medium deodorization filter can be cleaned by using the vacuum cleaner.

Medium deodorization filter is a urethane foam type which applied AC powder.

■ ANTI-FLU HEPA™ filter

Coway's innovative ANTI-FLU HEPA™ captures micro particles and inactivates viruses up to 99.9 %. Natural substances from Ginkgo and Japanese sumac trees destroy the protein on the surface of viruses.

* This appliance is not a medical device.

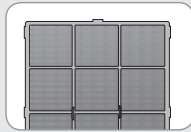

1. UFY Pre-filter

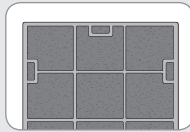

2. Medium Deodorization filter

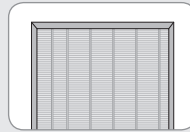

3. ANTI-FLU HEPA™ filter

PREPARATIONS

Please Check Before Use!

- ⚠** The product is for 220 V-240 V~, 50 Hz/60 Hz only.
Make sure to connect the power plug to a grounded electric outlet (220 V-240 V~, 50 Hz/60 Hz) dedicated to the product.

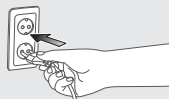

How to install filter



Tips

- Make sure to remove each filter's plastic packing before installing filters.
 - The product is for household use. Use the product indoors only.
 - When the product is not in use, remove the power plug from the electric outlet.
 - When installing filters, check that the front side of filters is in the correct direction.
- ▶ Order of filters : UFY pre-filter→Medium deodorization filter→ANTI-FLU HEPA™ filter

1. Open the front cover.

Open the front cover by pulling the lower part of it.

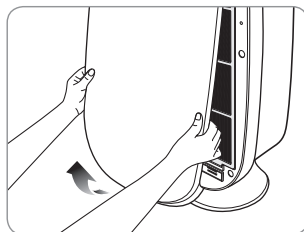

2. Take out filters and remove the plastic packing.

Remove the plastic packing of the filters except the pre-filter and then install filters according to the order of filters.

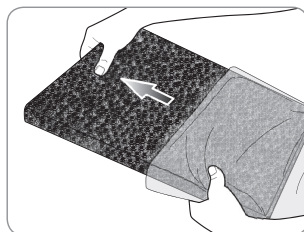
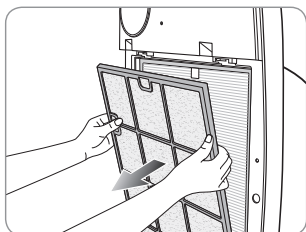

INDICATORS AND CONTROLS

Operation part

■ Controls

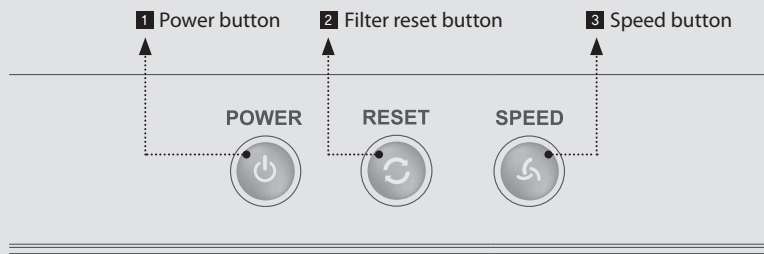

POWER



1 Power button

Use it to turn the product On/Off.

* To turn off the power, press and hold the power button for approximately 1 second.

RESET



2 Filter reset button

To begin reset mode, press and hold the reset button for approximately 1 second. To set filter reset in reset mode, press and hold the reset button for approximately 1 second again. If the power/speed button is pressed or 20 seconds have passed in reset mode, the reset mode is cancelled.



SPEED



3 Speed button

Use it to select the desired airflow speed.

INDICATORS AND CONTROLS

Indication part

● Indicators

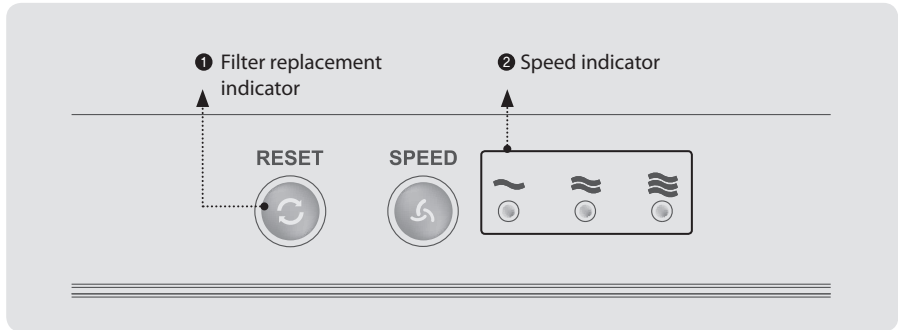

RESET



1 Filter replacement indicator

When the filter needs to be replaced, indicator is turned on.

In reset mode, blinking speed LED indicates a filter that needs to be replaced.

Step 1 LED : Medium deodorization filter, Step 2 LED : ANTI-FLU HEPA™ filter
To set reset in reset mode, press and hold the reset button for approximately 1 second again.

If the power/speed button is pressed or 20 seconds have passed in reset mode, the reset mode is cancelled.



2 Speed indicator

By using the speed button, it is possible to select the airflow speed in 3 steps. (Step1 → Step2 → Step3)

HOW TO USE



Tips

- Before operating the product, connect the power plug to a dedicated electric outlet.
- Once the power is turned on, you will see the previously used operation mode, already set for you to use.

■ To operate the manual mode

Press the power button and then select the speed of wind by pressing the speed button.

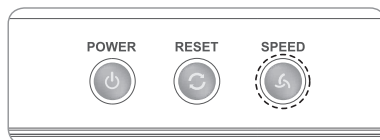
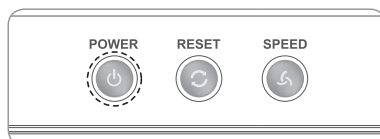

CLEANING METHOD

- Always unplug the product before cleaning the filter.
- The pre-filter is reusable by removing dust or cleaning it with water.
- If the pre-filter is not cleaned for a long time, the product performance may deteriorate.
- The medium deodorization filter is reusable with vacuum cleaning.
Never clean them with water.

■ Cleaning

1. Open the front cover by pulling the lower part of it.

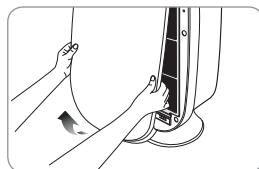

2. Press the hook above the pre-filter and take out the pre-filter by pulling out on the handles.

- * To prevent dust from falling off, remove the filter carefully without exerting a shock.

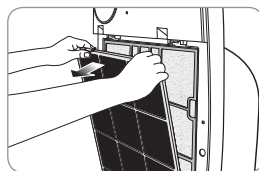

3. Clean the pre-filter with a vacuum cleaner or with water depending on the level of contamination. (every 2 ~ 4 weeks)

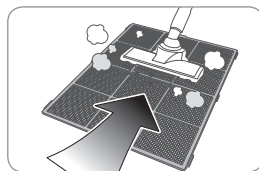

4. Clean the medium deodorization filter and with a vacuum cleaner. (every 2 ~ 4 weeks)

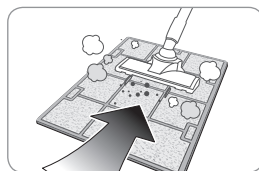

5. Install the pre-filter after removing the moisture completely. Fit the front cover back to the product.

- * When refitting the Pre-filter to the product, fit in the hook correctly.

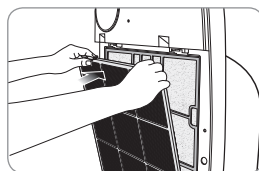



Tips

- Always unplug the air purifier before cleaning the product.
- Do not use detergents that contain organic solvents (solvent, thinner, etc), bleach, chlorine, or abrasives.
- Do not put the air purifier in water or spray water directly on it.

■ Cleaning the air inlet and outlet (every 2 months)

Clean the air inlet and outlet with a soft brush.

- * Exercise caution not to have dust fall inside the air purifier.

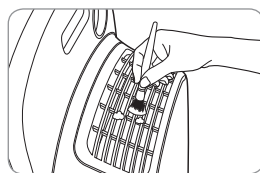

■ Cleaning the front cover

Separate the front cover from the product and remove the dust attached to the surface with a soft dry brush or cloth.

- * Use lightly wet cloth if the contamination is serious but do not use abrasives.



■ Cleaning the product body (every 2 ~ 4 weeks)

Clean the air inlet and outlet with a soft brush.

- * Exercise caution not to have dust fall inside the air purifier.

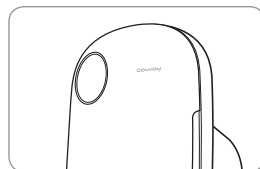

FILTER REPLACEMENT

- Always unplug the air purifier before cleaning the product.
- Do not use detergents that contain organic solvents (solvent, thinner, etc), bleach, chlorine, or abrasives.
- Do not put the air purifier in water or spray water directly on it.

■ Filter cleaning and replacement cycles.

Filter	cycles	method
UFY Pre-filter	Every 2 ~ 4 weeks	Cleaning
Medium Deodorization filter	Every 2 ~ 4 weeks	Vacuum Cleaning
	Every 12 months	Replacement
ANTI-FLU HEPA™ filter	Every 36 months	Replacement

- * Each service life is based on 24-hour use in Speed step 1.
- * The recommended filter replacement cycles may differ depending on the operating environment.

■ Setting filter reset

1. After replacing filter, turn on the power.
 2. To begin reset mode, press and hold the reset button for approximately 1 second.
 3. To set reset, press and hold the reset button for approximately 1 second again.
- * If the power/speed button is pressed or 20 seconds have passed in reset mode, the reset mode is cancelled.

■ Forcible reset mode

When you have replaced a filter before the filter replacement cycle is reached.

1. Press and hold the reset button for 1 second(forcible reset).
2. Push the speed button to select the replaced filter.
When selecting the desired airflow LED, LED is blinked.
Step 1 LED : Medium deodorization filter , Step 2 LED : ANTI-FLU HEPA™ filter
Step 1 + 2 LED : Medium deodorization filter & ANTI-FLU HEPA™ filter
3. To set forcible reset, press and hold the reset button for approximately 1 second.

When the power button is pressed or 20 seconds have passed in the forcible reset mode, the forcible reset mode is cancelled.

TROUBLESHOOTING

The air purifier may operate abnormally not because of the product malfunction but because of minor causes or the fact that the user is not familiar with the product use. In such a case, problems can be solved easily even without the help from the service center just by checking the following. If the problem still persists after you check the following, contact the service center.

Symptom	Check	Measures to take
No air is blowing.	• Is the power cord connected?	Connect the power cord to an electric outlet for 220 V-240 V~, 50 Hz/60 Hz.
	• Is the display part all turned off?	Press the power button and then select the desired function.
	• Isn't the power gone out?	Use the air purifier after the power comes back on.
The airflow speed is significantly weaker than before.	• Isn't the filter cleaning or replacement time passed?	Check the filter cleaning and replacement cycles and then clean/replace the filter(s) if necessary.
A bad smell comes out of the air outlet.	• Isn't the filter cleaning or replacement time passed?	Check the filter cleaning and replacement cycles and then clean/replace the filter(s) if necessary.
When other functional problems are detected.	• Check the symptoms, unplug the product, and then request service or ask service center.	

SPECIFICATION

Product	Air Purifier
Model	AP-0509DH
Rated voltage	220 V - 240 V~, 50 Hz/60 Hz
Phase	1
Power consumption	43 W, 0.36 A
Product insulation grade	Grade 2 device
Dust clection mode	Mechanical dust collection method (HEPA filter)
Safety feature	Power is shut down when the front cover is opened
InsTallation place	Indoor use
Maximum volume of air	3.6 m ³ / min
Size	311.9 mm(W) X 197.4 mm(D) X 573 mm(H)
Weight	5.0 kg

- The specifications are subject to minor changes to improve the product performance.

MEMO

MEMO



MEMO

WARRANTY CARD OR WARRANTY LETTER
ONE YEAR LIMITED WARRANTY
AIR PURIFIER AP-0509DH ("PRODUCT")

Model:

Serial Number:

Customer Name:

("OWNER")

Date of Purchase:

What This Warranty Covers:

Commencing with the date of purchase of the Product and continuing for a period of one year, if manufacturing defects in the Product cause the Product to not operate properly for its intended use, then subject to the exclusions, conditions, and limitations contained herein, COWAY at its sole option will repair or replace the Product.

Decisions as to the extent of repair or replacement required will be made solely by COWAY.

The remedy under this Warranty is available only for that portion of the Product exhibiting defects at the time of the warranty claim. The replacement Product as well as any remaining original Product will be warranted only for the original one year warranty period. This limited warranty applies only to Product used for an application specified by COWAY for the Product and applied in strict accordance with COWAY published specifications in effect at the time of application. IF PRODUCT IS USED FOR OTHER THAN ITS INTENDED PURPOSE, IT IS SOLD AS IS AND WITHOUT ANY EXPRESS OR IMPLIED WARRANTIES, INCLUDING OF MERCHANTABILITY OR FITNESS FOR A PARTICULAR PURPOSE.

What This Warranty Does Not Cover:

This Warranty warrants that the Product will be free from manufacturing defects which affect the ability of the Product to operate for its intended use; it is not a warranty that the Product will never require repairs or to undertake responsibilities, liabilities or obligations other than those specifically identified in the preceding section. COWAY is not responsible or liable for personal injury or property damage of any kind, even if arising from a breach of this Warranty.

Limitations and Exclusions:

TO THE EXTENT PERMITTED BY APPLICABLE LAW, COWAY DISCLAIMS ANY OTHER WARRANTY EXPRESS OR IMPLIED, THAN THAT PROVIDED FOR HEREIN. THIS WARRANTY IS IN LIEU OF AND EXCLUDES ALL OTHER WARRANTIES, GUARANTEES, CONDITIONS AND REPRESENTATIONS, EXPRESS OR IMPLIED, ORAL OR WRITTEN, STATUTORY OR OTHERWISE, INCLUDING BUT NOT LIMITED TO ANY IMPLIED CONDITIONS OR WARRANTIES AS TO THE MERCHANTABILITY OR FITNESS FOR A PARTICULAR PURPOSE OF THE COWAY PRODUCT. SOME STATES DO NOT ALLOW LIMITATIONS ON HOW LONG AN IMPLIED WARRANTY LASTS, SO THE ABOVE LIMITATION MAY NOT APPLY TO YOU. COWAY DOES NOT AUTHORIZE ANY PERSON INCLUDING ITS REPRESENTATIVES, TO MAKE ANY REPRESENTATION OR TO OFFER ANY WARRANTY, CONDITION OR GUARANTY IN RESPECT OF THE PRODUCT OTHER THAN THIS WARRANTY. THIS LIMITED WARRANTY SHALL BE THE OWNER'S SOLE AND EXCLUSIVE REMEDY AGAINST COWAY AND COWAY SHALL NOT BE LIABLE FOR ANY CONSEQUENTIAL, EXEMPLARY, SPECIAL, INCIDENTAL OR OTHER DAMAGES INCLUDING, BUT NOT LIMITED TO, LOSS OF PROFITS, AND LOSS OF USE. INCIDENTAL, CONSEQUENTIAL AND EXEMPLARY DAMAGES SHALL NOT BE RECOVERABLE EVEN IF THE REMEDIES OR THE ACTIONS PROVIDED FOR IN THIS WARRANTY FAIL OF THEIR ESSENTIAL PURPOSE. SOME STATES DO NOT ALLOW THE EXCLUSION OR LIMITATION OF INCIDENTAL OR CONSEQUENTIAL DAMAGES, SO THE ABOVE LIMITATION OR EXCLUSION MAY NOT APPLY TO YOU. COWAY SHALL NOT BE LIABLE FOR ANY DAMAGES WHICH ARE BASED UPON NEGLIGENCE, BREACH OF WARRANTY, STRICT LIABILITY OR ANY OTHER LEGAL THEORY OF LIABILITY OTHER THAN THE EXCLUSIVE LIABILITY SET FORTH IN THIS WARRANTY.

Limitations on Implied Warranties:

Any implied warranty of merchantability or fitness for a particular purpose or use, shall be limited to the duration of the foregoing express written warranty.

Conditions of Warranty:

COWAY's continuing liability under this Warranty is conditioned upon the following :

- a) The defect or damage is not caused by or is the result of : abnormal use or conditions; improper storage, unauthorized modifications or repair; misuse, neglect, accident, alteration, improper installation or other acts that are not the fault of Coway or the manufacturer of the product or that are not covered by the manufacturer's warranty;
- b) The Product has not been altered, modified or repaired without prior written approval of COWAY;
- c) The OWNER has notified COWAY in writing of any failure of the Product covered by this Warranty within thirty (30) days following such failure;
- d) There has been no misuse, abuse or negligence with respect to the Product on the part of the OWNER.

Waiver:

COWAY's failure at any time to enforce or rely upon any of the terms or conditions stated herein shall not be construed to be a waiver of its rights hereunder.

Obtaining Warranty Service and OWNER'S Duties:

If the Product fails to operate for its intended purpose, then notify Coway or its Representative Agency within 48 hours or within the next business day after discovery of any defect in the Product. The OWNER must give written notice to COWAY no later than thirty (30) days after a defect is discovered or should by reasonable diligence have been discovered. Claims under this Warranty will require proof of purchase by the OWNER.

COWAY

Add : Coway co., Ltd.
136-23, Yugumagoksa-ro, Yugu-eup, Gongju-si,
Chungcheongnam-do, Korea
Tel. : 82-41-850-7879
Fax. : 82-41-841-7816

SWEDEN

Add : Albion Nordic AB Traktorgatan 2 745 37
Enköping Sweden
Tel. : +46 171 66 33 00
Mail : info@albionnordic.com
Web : www.albionnordic.com

coway

www.coway.com